

How to adjust camera settings (MM core 6.1)

First option:

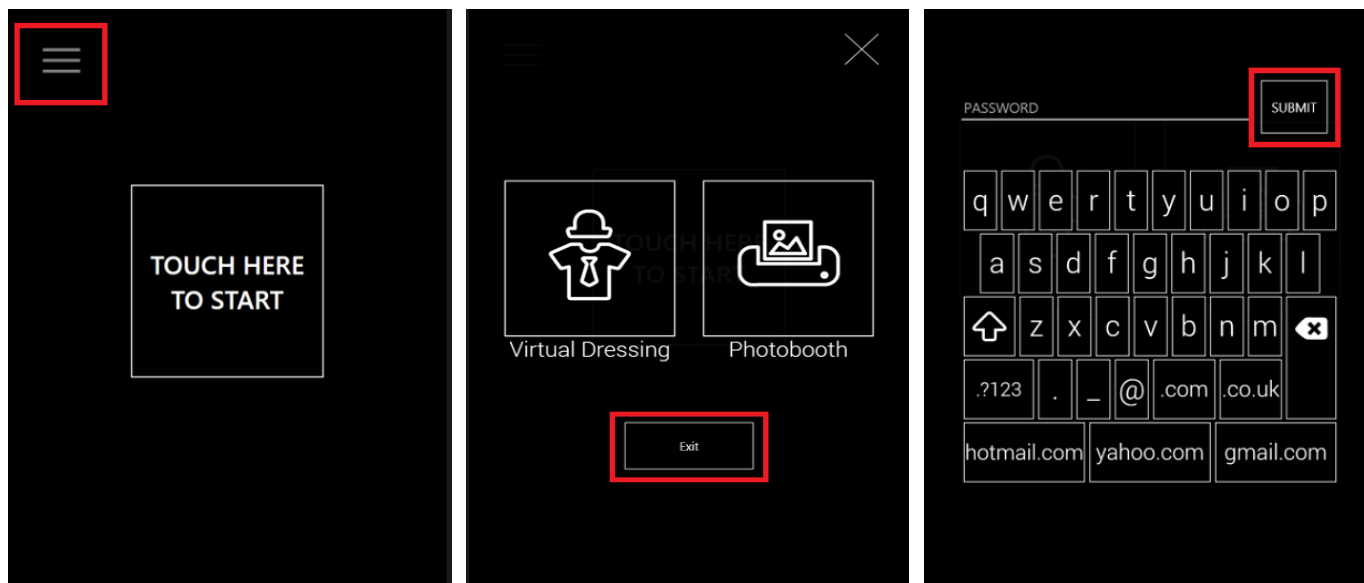

1. Tap on **☰** icon on the top left corner of the touchscreen.
2. Tap on **Exit**.
3. Password to exit is **mm**.
4. Tap on **submit** to exit.

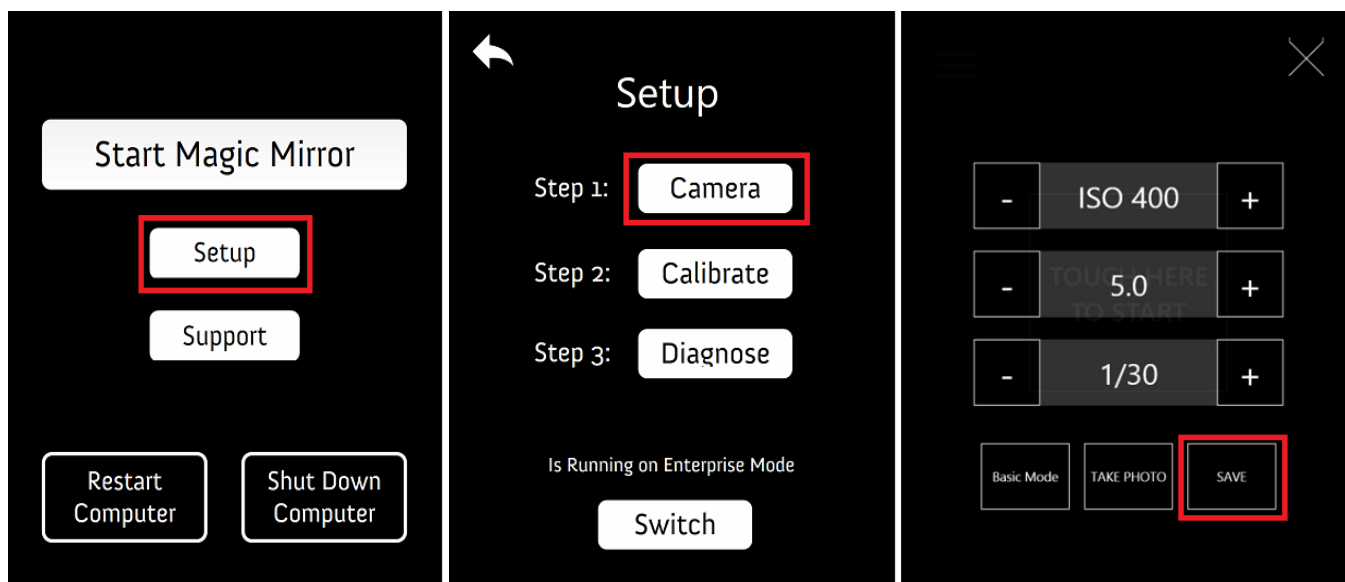

5. You will reach the Magic Mirror launcher page.
6. Tap on **Setup**.
7. Select **Step 1: Camera**.
8. Camera setting page will be shown.
9. Adjust the **settings**.
10. Tap on **Save** to save all the changes.

Second option:

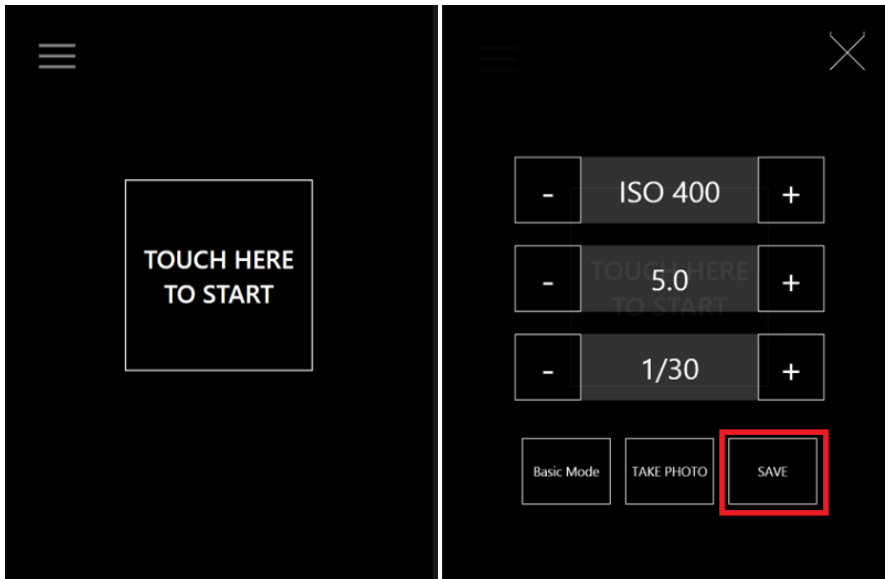

1. Open a Magic Mirror module.
2. Press on "**Ctrl+Shift+C**" key on the keyboard.
3. Camera setting page will be shown.
4. Adjust the **settings**.
5. Tap on **Save** to save all the changes.